

BILL of MATERIALS

Qty.	DESCRIPTION
	OVERALL HEIGHT 9.79"

NO.	REVISION	DATE
-----	----------	------

PART TO RECEIVE 1/2" FOAM  
AROUND EXTERIOR SURFACES

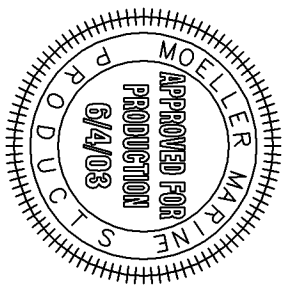
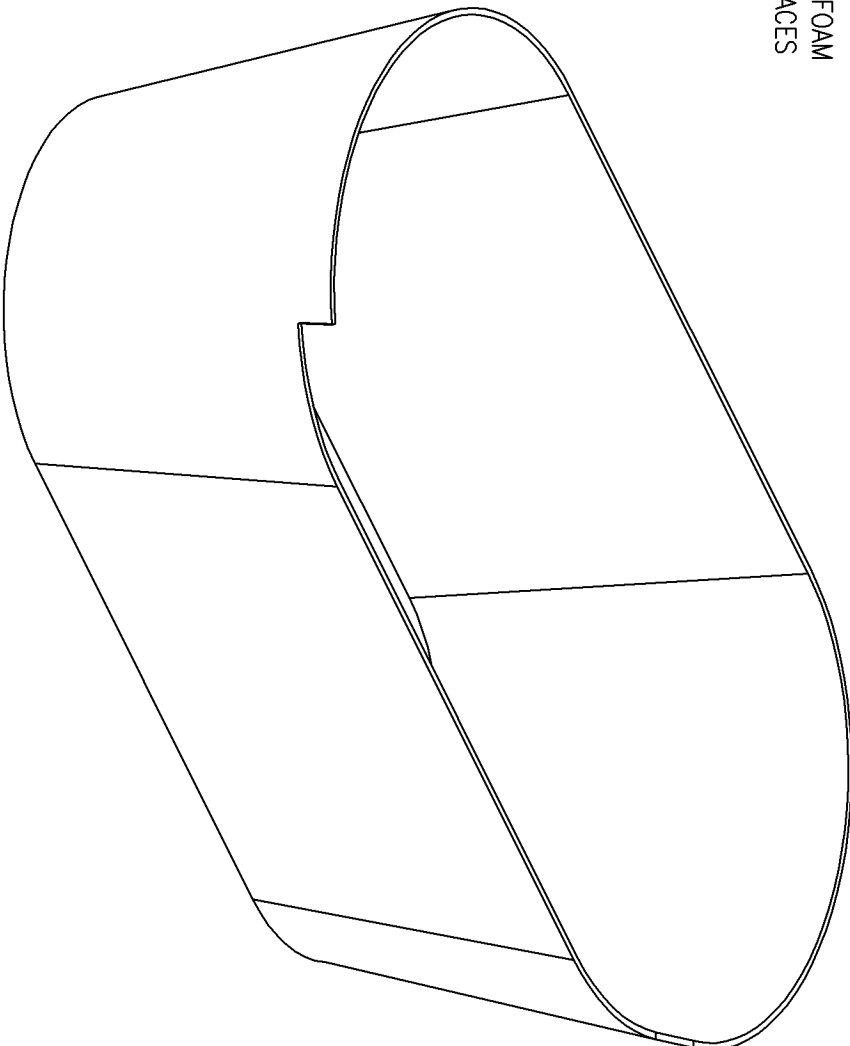

NOTE: ALL EDGES R0.3750  
UNLESS OTHERWISE NOTED

PAGE 1 OF 3

THIS DRAWING AND THE ATTACHED DRAWINGS (AND THE DATA SHOWN THEREON) IS CONFIDENTIAL AND PROPRIETARY AND SHALL NOT BE USED, DISCLOSED TO OTHERS, REPRODUCED FOR ANY PURPOSE EXCEPT FOR QUOTATION TO OR ORDER BY MOELLER MARINE PRODUCTS, INC. AND/OR ITS SUBSIDIARIES WITHOUT THEIR WRITTEN CONSENT TO THE USE OF SUCH DRAWINGS AND/OR DATA.

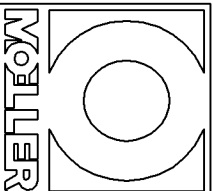

DESCRIPTION	9 GALLON LIVEWELL		
PART #	LW-316	COLOR	BRIGHT WHITE
MATERIAL	LINEAR POLYETHYLENE		
TOLERANCES	±1.5% UNLESS OTHERWISE NOTED		
WALL THK.	0.150"	DATE	10/1/97
DRAWN BY	MOELLER ENGINEERING		

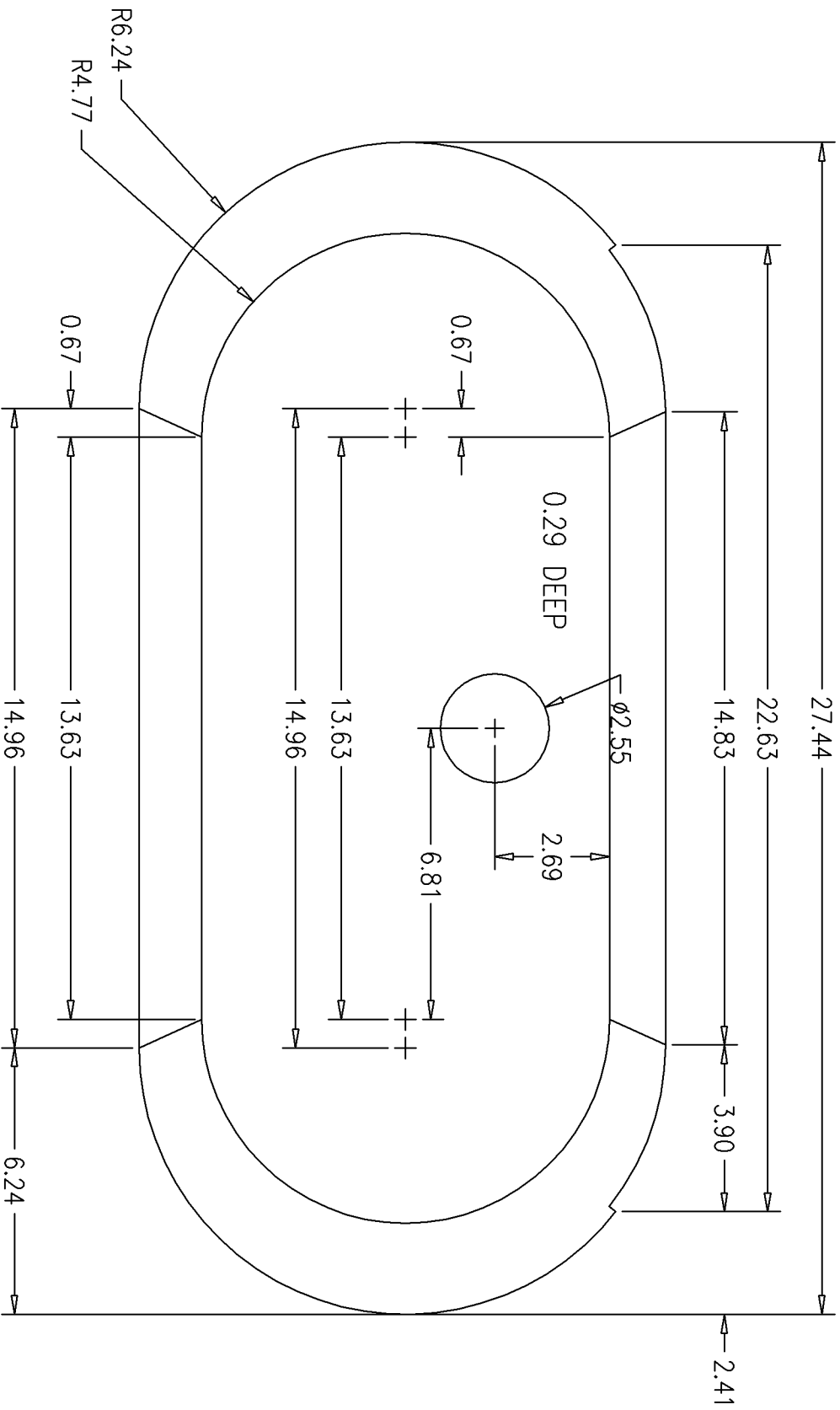

BOTTOM VIEW  
 10/1/97

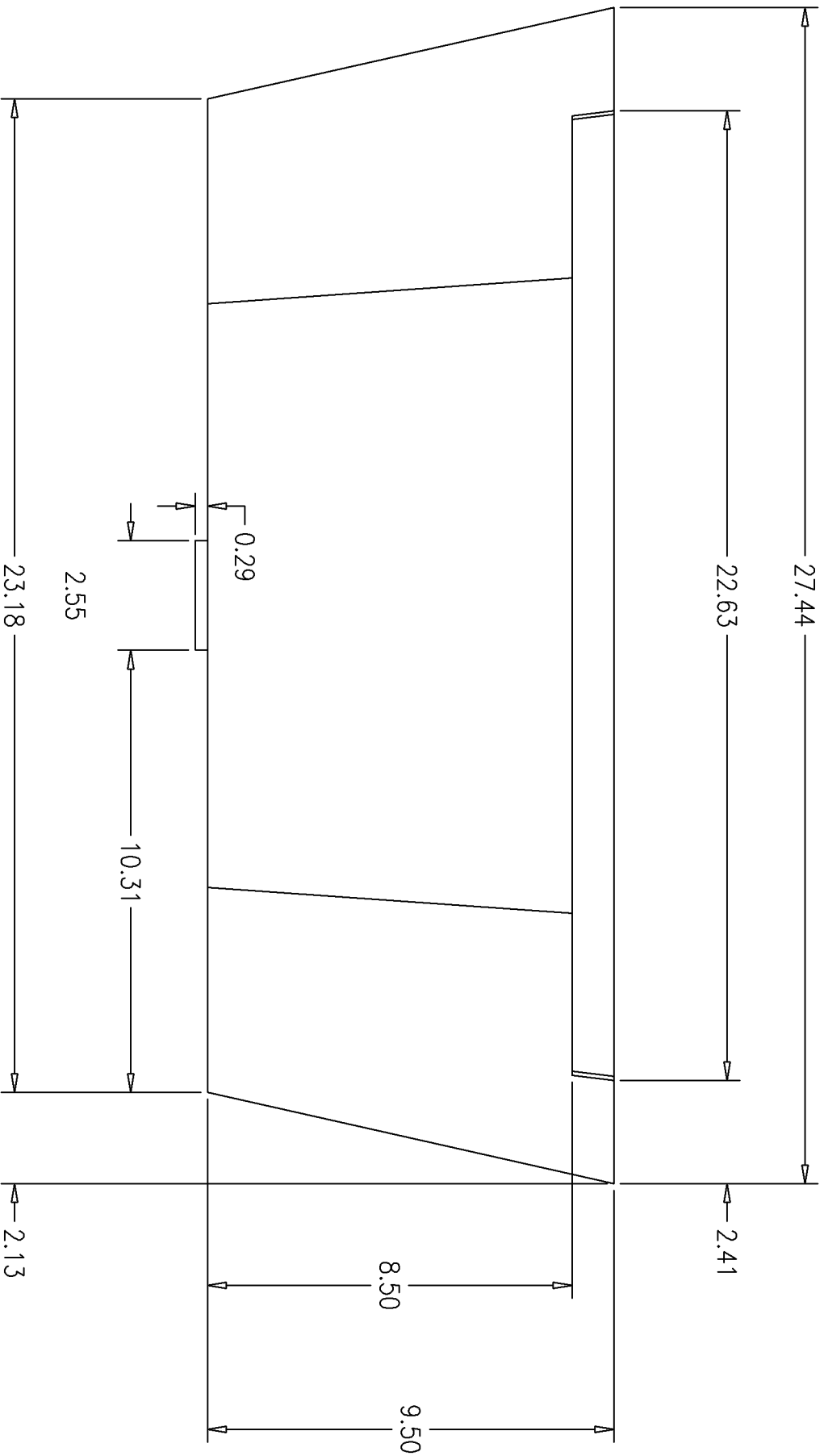

FRONT VIEW  
 10/1/97