

BILL of MATERIALS

Qty.	DESCRIPTION
1	2.25" KELCH CAP W/ 10.00" GAUGE
2	1/8" NPT INSERT W/ PLUG
	OVERALL HEIGHT 10.69"

NO.	REVISION	DATE
1	REPLACE 1/4" INSERT W (2) 1/8" NPT INSERTS	6/12/01

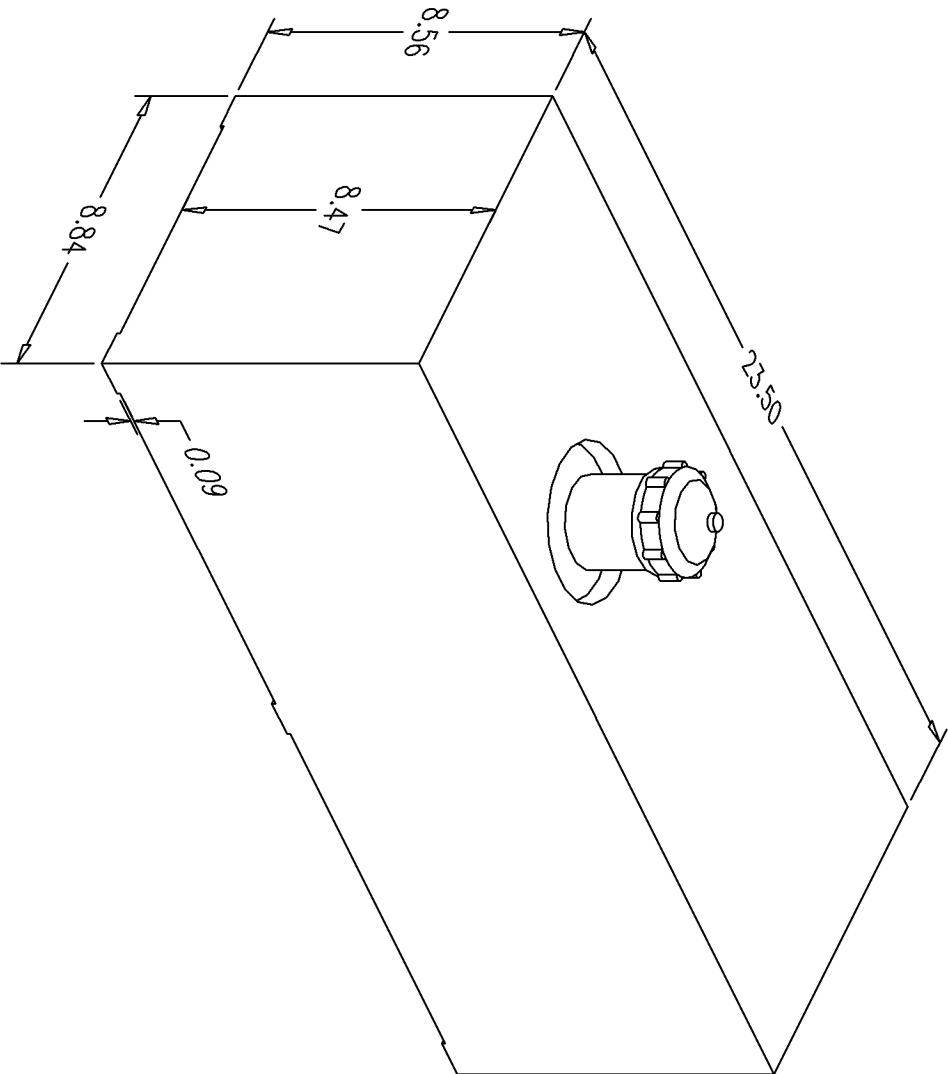

NOTE: ALL EDGES R0.38
UNLESS OTHERWISE NOTED

PAGE 1 OF 4

THIS DRAWING AND THE ATTACHED DRAWINGS (AND THE DATA SHOWN THEREON) IS CONFIDENTIAL AND PROPRIETARY AND SHALL NOT BE USED, DISCLOSED TO OTHERS, REPRODUCED FOR ANY PURPOSE EXCEPT FOR QUOTATION TO OR ORDER BY MOELLER MARINE PRODUCTS, INC. AND/OR IT'S SUBSIDIARIES WITHOUT THEIR WRITTEN CONSENT TO THE USE OF SUCH DRAWINGS AND/OR DATA.

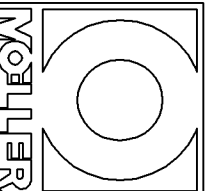

DESCRIPTION	7 GALLON FUEL TANK		
PART #	ID0180	COLOR	BLACK
MATERIAL	CROSSLINK POLYETHYLENE		
TOLERANCES	±1.5% UNLESS OTHERWISE NOTED		
WALL THK.	0.200 NOMINAL	DATE	6/12/01
DRAWN BY	MOELLER ENGINEERING		

