

NO.	REVISION	DATE
1	REPLACED MOLDED VENT W/ VENT W/ 5/8 BARB	2/8/07
2	CHANGE P/U BARB TO A000111	4/16/08

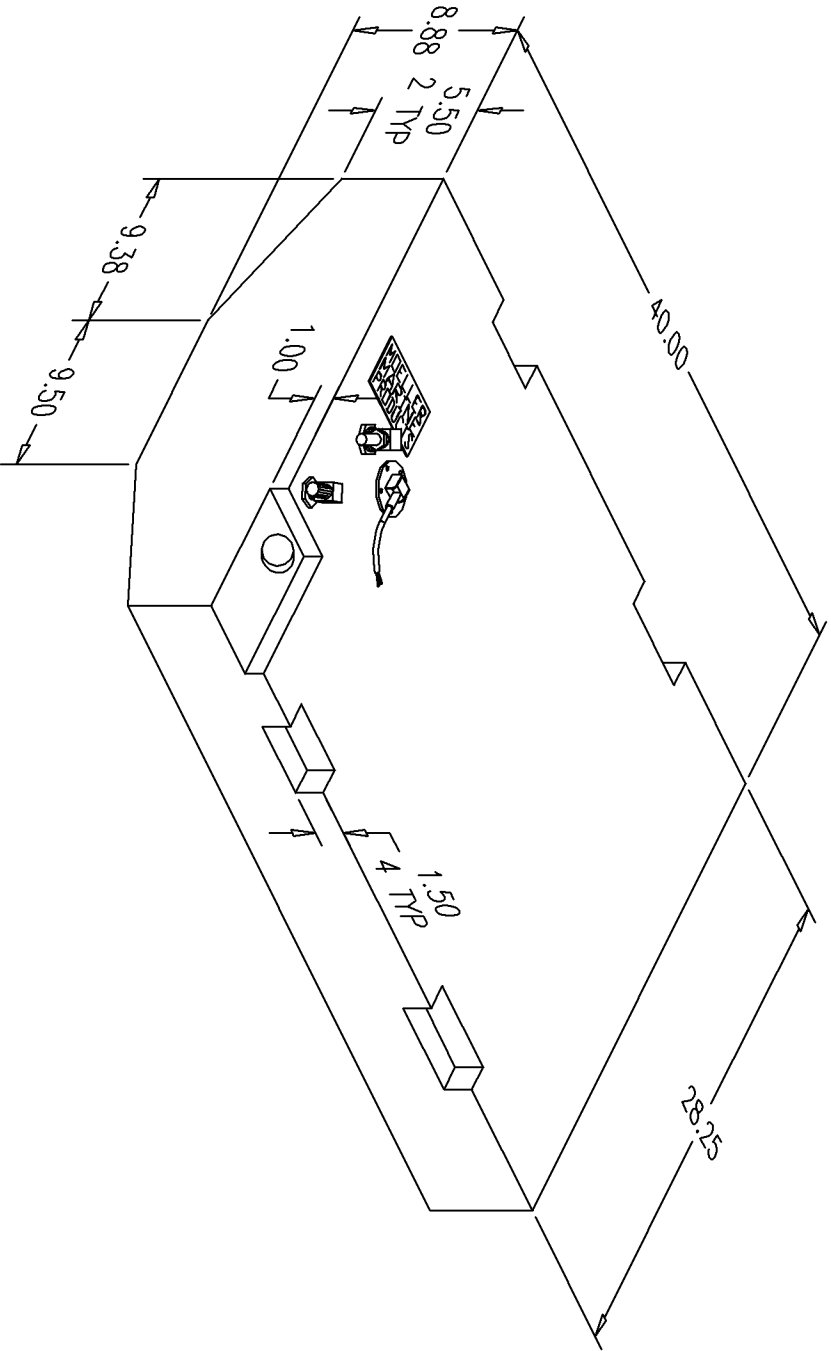

NOTE: ALL EDGES R0.38
UNLESS OTHERWISE NOTED

PAGE 1 OF 3

© 2007 MOELLER MARINE PRODUCTS
ALL RIGHT RESERVED

THIS DRAWING AND THE ATTACHED DRAWINGS (AND THE DATA SHOWN THERON) IS CONFIDENTIAL AND PROPRIETARY AND SHALL NOT BE USED, DISCLOSED TO OTHERS, REPRODUCED FOR ANY PURPOSE EXCEPT FOR QUOTATION TO OR ORDER BY MOELLER MARINE PRODUCTS, INC. AND/OR IT'S SUBSIDIARIES WITHOUT THEIR WRITTEN CONSENT TO THE USE OF SUCH DRAWINGS AND/OR DATA.

NOTE: THIS IS AN ADDITIONAL LID FOR
FT35333 MOLD BOTTOM

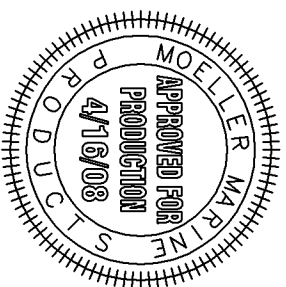

DESCRIPTION	35 GALLON TANK		
PART #	FT3542	COLOR	NATURAL
MATERIAL	CROSSLINK POLYETHYLENE		
TOLERANCES	±1.5% UNLESS OTHERWISE NOTED		
WALL THK.	0.200" NOMINAL		
DRAWN BY	MOELLER ENGINEERING	DATE	4/16/08

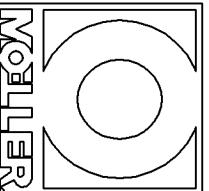

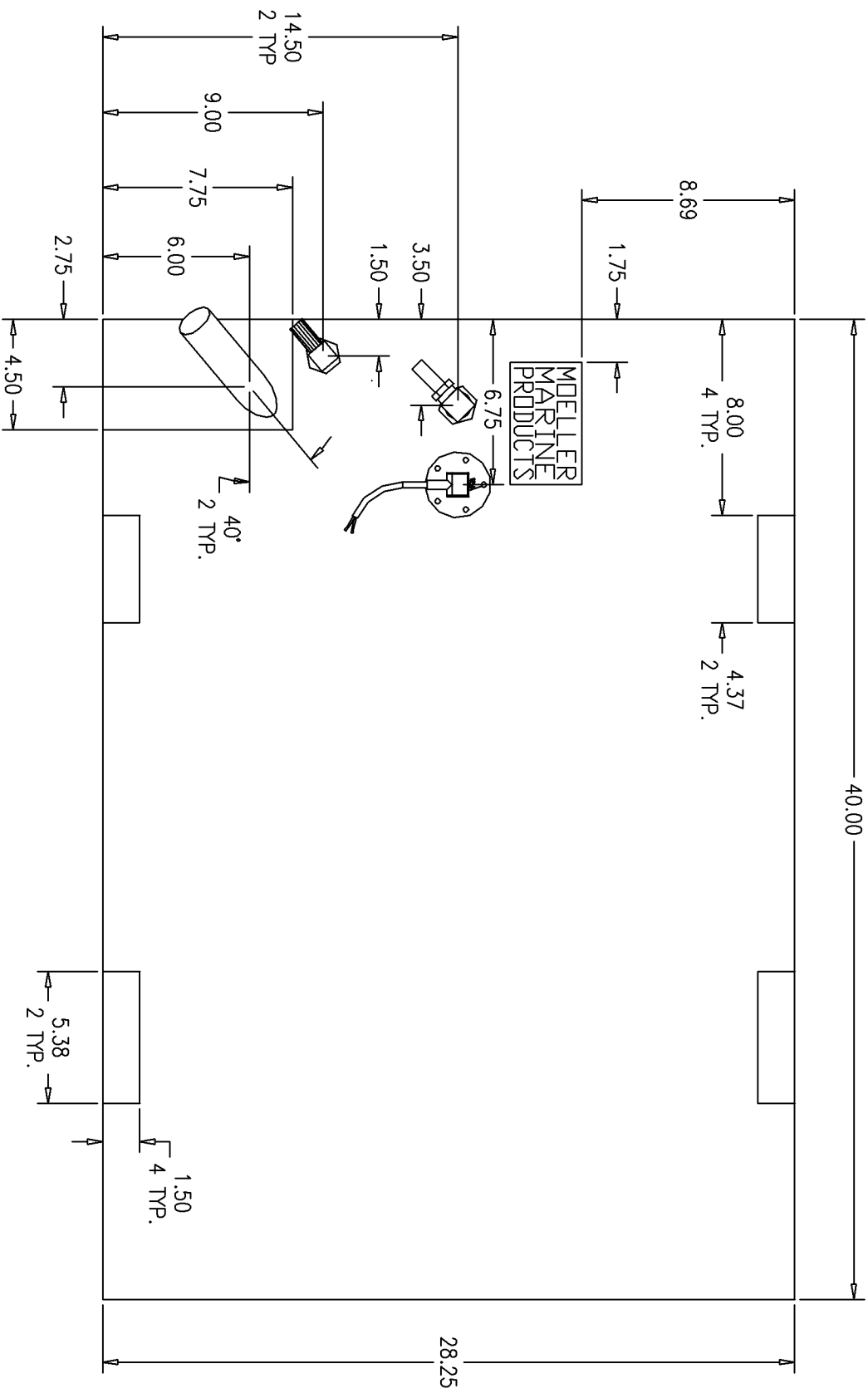

TOP VIEW
4/16/08

NOTE: FILL IS Ø1.50, 2.75 ON SHORT SIDE, AND ANGLED 30° FROM TOP OF TANK.
VENT IS ANGLED SAME AS FILL.
PICKUP IS ROTATED 45°.

