

BILL of MATERIALS

Qty.	DESCRIPTION
1	ROCHESTER ECONOMY SENDER
1	PICKUP w/ 3/8 BARB
1	3/8 NPT INSERT w/ 5/8 BARB (VENT)
6	10-24 INSERTS
	Ø1.50 MOLDED FILL
	OVERALL HEIGHT 15.25"

NO.	REVISION	DATE
1	REPLACE MOLDED VENT W/ ALUM.	6/1/04

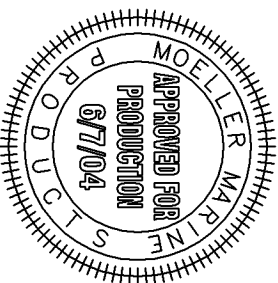
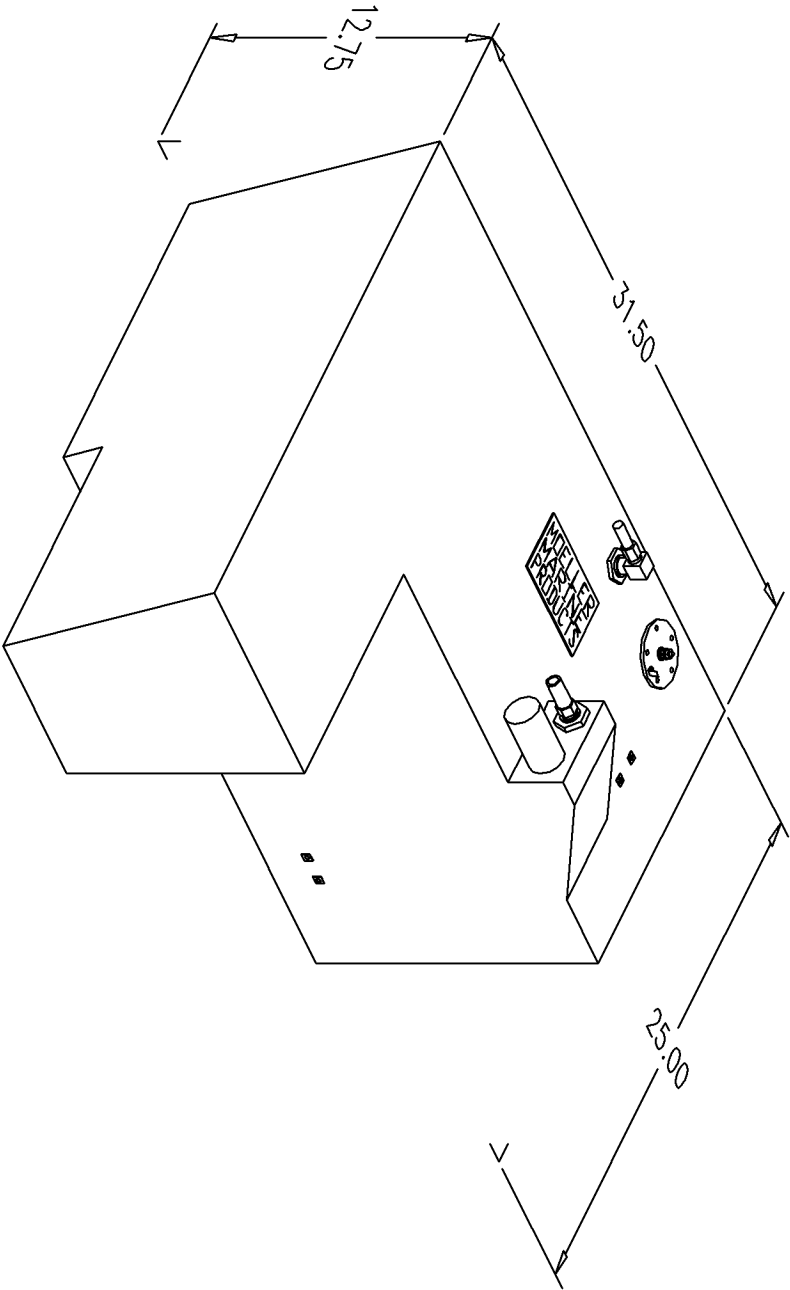

NOTE: ALL EDGES R0.38
UNLESS OTHERWISE NOTED

PAGE 1 OF 3

THIS DRAWING AND THE ATTACHED DRAWINGS (AND THE DATA SHOWN THEREON) IS CONFIDENTIAL AND PROPRIETARY AND SHALL NOT BE USED, DISCLOSED TO OTHERS, REPRODUCED FOR ANY PURPOSE EXCEPT FOR QUOTATION TO OR ORDER BY MOELLER MARINE PRODUCTS, INC. AND/OR IT'S SUBSIDIARIES WITHOUT THEIR WRITTEN CONSENT TO THE USE OF SUCH DRAWINGS AND/OR DATA.

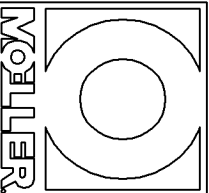

DESCRIPTION	25 GALLON PORT FUEL TANK		
PART #	FT2532	COLOR	NATURAL
MATERIAL	CROSSLINK POLYETHYLENE		
TOLERANCES	±1.5% UNLESS OTHERWISE NOTED		
WALL THK.	0.200" NOMINAL	DATE	6/1/04
DRAWN BY	MOELLER ENGINEERING		

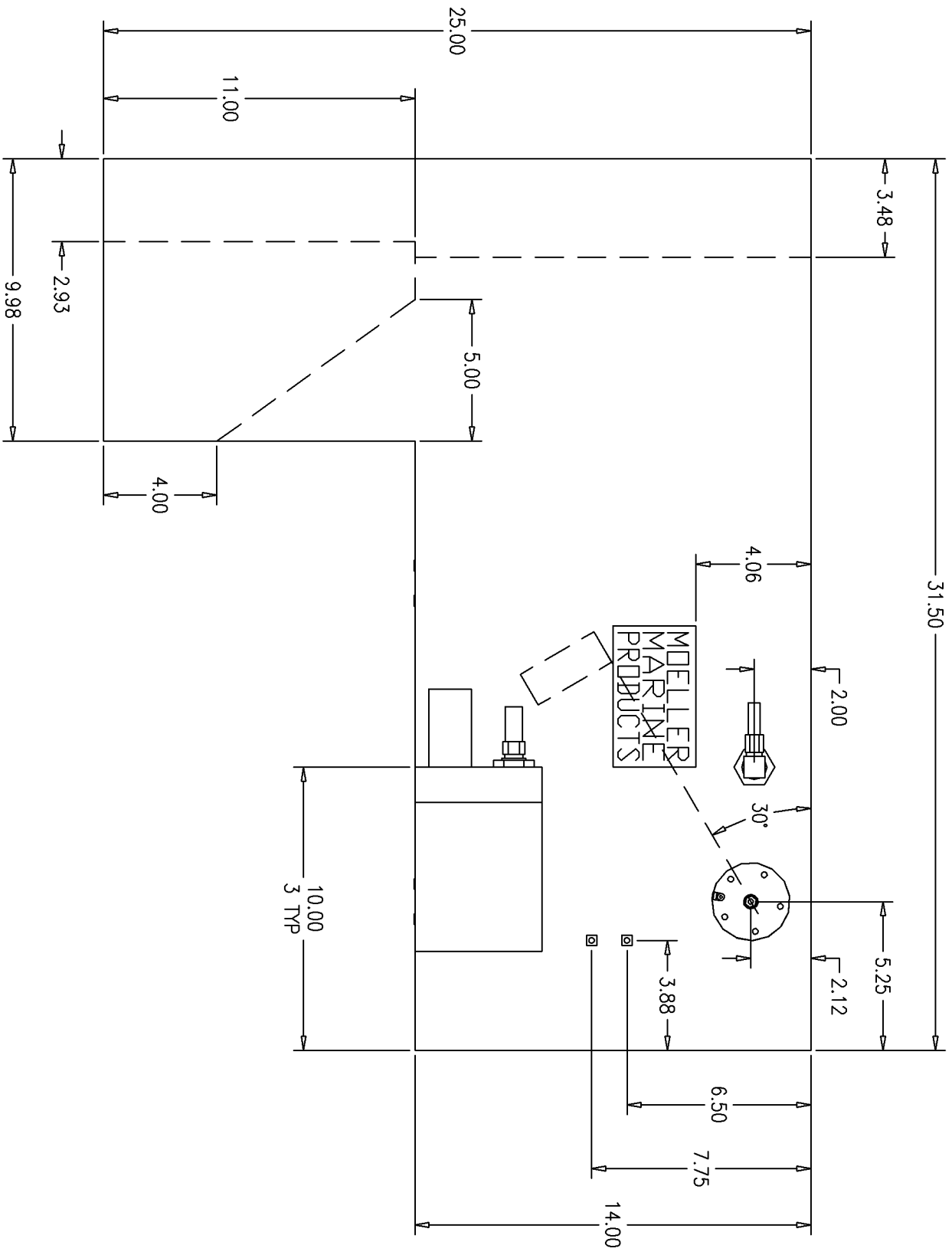

NOTE: DOGHOUSE IS 6.50 LONG, 4.50 WIDE, 2.50 TALL, AND HAS A 1.25 FLAT ON TOP.

